

Lithium Iron (LiFePO₄) Battery

ALFP-48100(51.2V 100Ah)

Features

Longer Cycle Life: Offers up to 10 times longer cycle life and five times longer float/calendar life than lead acid battery, helping it minimize replacement cost and reduce total cost of ownership.

Lighter Weight: About 40% of the weight of a comparable lead acid battery. A 'drop in' replacement for lead acid batteries.

Higher Power: Delivers twice power of lead acid battery, even high discharge rate, while maintaining high energy capacity.

Wider Temperature Range: -20 ~ 60°C

Superior Safety: Lithium Iron Phosphate chemistry eliminates the risk of explosion or combustion due to high impact, overcharging or short circuit situation.

Multi Protocol: The battery work well with multiple brands of inverters.



Dimension-mm

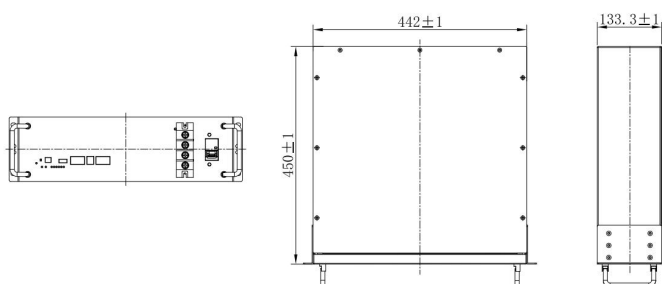

Application

- Indoor/outdoor telecom base stations
- Household energy storage system
- Smart transportation backup power supply

Specification

Basic Parameters	Rated Voltage	51.2V
	Rated Capacity	100Ah
	Rated Energy	5120wh
	Combination Method	16S1P
	Cycle Life	≥6000 cycles @80%DOD
	Self Discharge	1%/months
	Efficiency of Charge	≥97%
	Efficiency of Discharge	≥98%
Charge	Charge Voltage	57.6V
	Charge Current (Recomm.)	20A
	Charge Current (Max.)	100A
Discharge	Discharge Cut-off Voltage	43.2V
	Discharge Current(Recomm.)	50A
	Pulse Current	120A (3S)
Environment	Charge Temperature	0°C to 60°C
	Discharge Temperature	-20°C to 60°C
	Humidity	5% to 95%
Physical Characteristics	IP Class	IP30
	Case Material	Metal
	Dimensions (mm)	442*133*450mm
	Weight (kg)	45kg
	Others(optional)	Anti-theft function, LCD display

Lithium Iron (LiFePO₄) Battery

ALFP-48100(51.2V 100Ah)

Different Rate Discharge Curve (25°C)

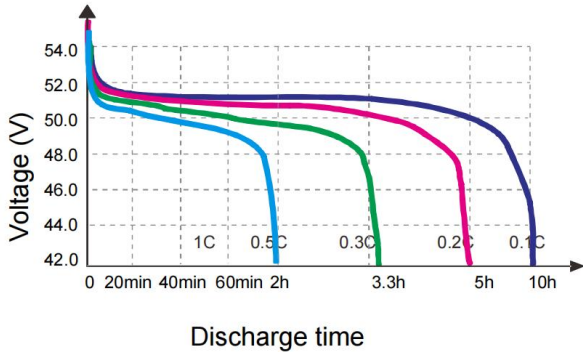

Different Temperature Discharge Curve (0.5C)

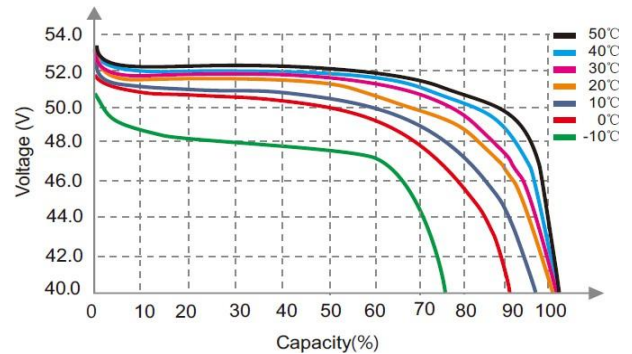

State of Charge Curve (0.5C, 25°C)

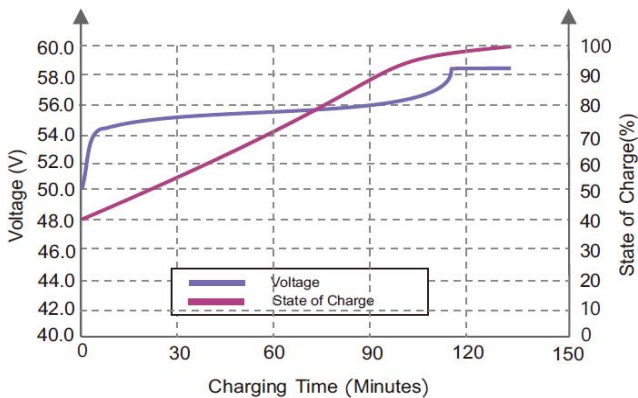

Charging Characteristics (0.5C, 25°C)

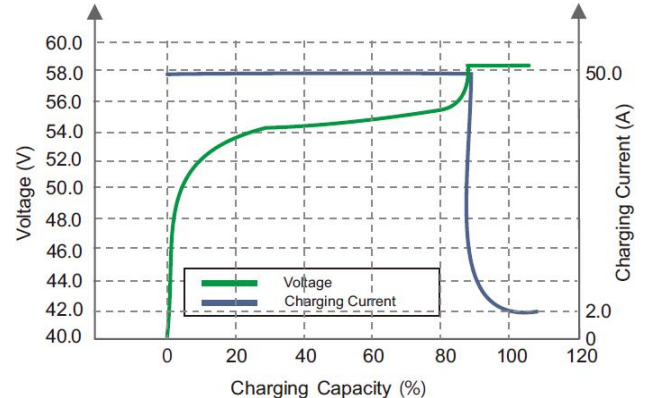

Different DOD Discharge Cycle Life Curve (0.5C)

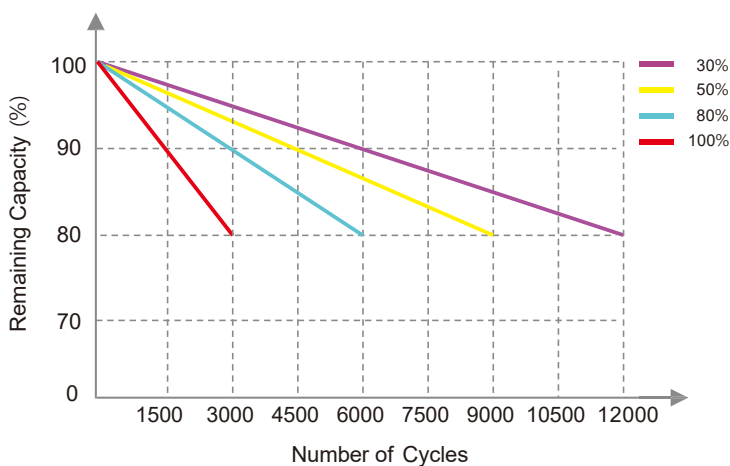

Different Temperature Self Discharge Curve

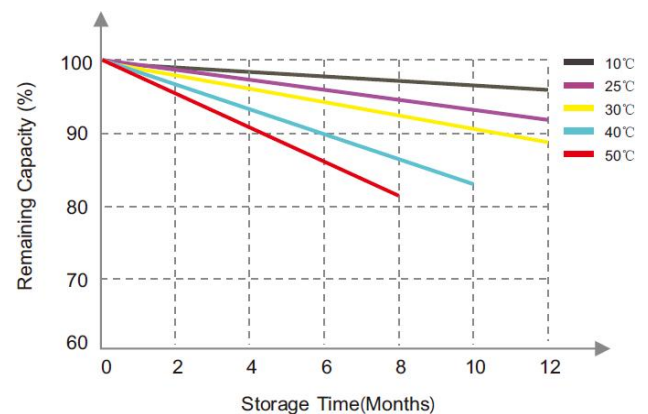

Add: High-tech Industrial Development Zone,
Yingde City, Guangdong Province, China
Web: www.aokly-battery.com
Email: sales@aokly-battery.com

© 2024 AOKLY GROUP. All rights reserved.

Trademarks and logos are the property of AOKLY GROUP and its affiliates unless otherwise noted. Subject to revisions without prior notice.